

# PPD

## Planet Plain Ram Oil Return – Double Acting

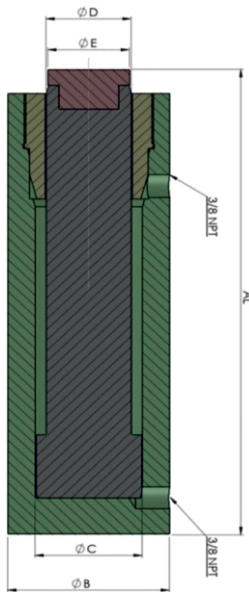

### APPLICATION

These jacks are designed to provide oil force in both the advance and retraction of ram, in vertical & horizontal position, where cycle time is crucial. These are mainly used for hydraulic testing machine and for lifting, lowering, spreading of structures, bridges, heavy machinery, etc.

### FEATURES /ADVANTAGES

- Alloy steel body for better life.
- Hard chrome-plated ram to resist scoring & corrosion.
- Ideal for heavy duty application.
- Suit general lifting & push pull applications.
- High pressure long life seals. Ram wiper protects inner cylinder from dirt which extends cylinder life.
- Relief valve protects against over pressurizing.
- Bottom mounting holes, collar threading are provided on request.
- Connection Port size 3/8 inch NPT.
- Available in custom strokes also.



**PPD Series** - P: Planet, P: Plain Rod, D: Double Acting Oil Return, 10: Capacity - ton, 150: Stroke - mm

Model	Cap in (ton)	Cap. in (kN)	Stroke in (mm)	"A" Close Height	Effective Area in (cm <sup>2</sup> )	Oil Cap in (cc)	"B" Cyl. OD	"C" Cyl. Bore ID	"D" Ram dia.	"E" Saddle dia.	wt. App in (kg)
PPD 10 - 150	10	111	150	275	15.9	239	75	45	30	28	8
PPD 15 - 150	15	167	150	280	23.8	356	85	55	40	38	11
PPD 20 - 150	20	218	150	285	31.2	468	95	63	50	48	14
PPD 25 - 150	25	270	150	295	38.5	577	95	70	55	53	14.3
PPD 30 - 150	30	309	150	305	44.2	663	100	75	55	53	15.6
PPD 50 - 150	50	550	150	305	78.5	1178	130	100	70	67	26.3
PPD 75 - 150	75	792	150	305	113.1	1696	155	120	90	87	38.5
PPD 100 - 150	100	1077	150	310	153.9	2309	180	140	110	106	53.5
PPD 150 - 150	150	1589	150	320	227.0	3405	220	170	140	137	84
PPD 200 - 150	200	2199	150	345	314.2	4712	255	200	150	146	116
PPD 250 - 150	250	2661	150	350	380.1	5702	280	220	180	177	148
PPD 300 - 150	300	3167	150	365	452.4	6786	310	240	180	177	181
PPD 400 - 150	400	4008	150	385	572.6	8588	350	270	220	216	255
PPD 500 - 150	500	4948	150	425	706.9	10603.5	400	300	250	240	375

- Specifications are subject to change due to continual improvement.
- Higher capacity and customized solution on request.
- Capacity and Stroke specified are maximum safe limits. Use at 80% of rating as safe practice.

